

Plungerzylinder

– Typ HFRT
mit angeschweissten Befestigungen –

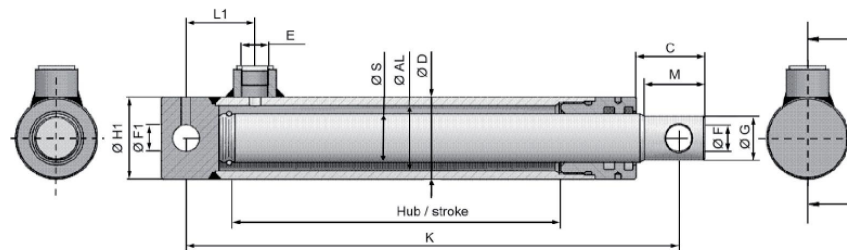

Typ	Bezeichnung	Hub	Ø D	Ø AL	Ø S	K	E	M	C	L1	Ø F Ø F1	Ø G	Ø H1	Kg
114-010-01000	EW25-100 CFHR	100	40	30	25	190	3/8"	35	38	40	14	22	40	1,63
114-010-01050	EW25-150 CFHR	150				240								2,04
114-010-01100	EW25-200 CFHR	200				290								2,44
114-010-01150	EW25-250 CFHR	250				340								2,85
114-010-01200	EW25-300 CFHR	300				390								3,26
114-010-01250	EW30-200 CFHR	200	50	40	30	300	3/8"	37	42	42	16	27	50	3,61
114-010-01300	EW30-250 CFHR	250				350								4,16
114-010-01350	EW30-300 CFHR	300				400								4,72
114-010-01400	EW30-350 CFHR	350				450								5,27
114-010-01450	EW30-400 CFHR	400				500								5,82
114-010-01500	EW30-550 CFHR	550				650								7,30
114-010-01550	EW40-200 CFHR	200				60								50
114-010-01600	EW40-250 CFHR	250	380	6,84										
114-010-01650	EW40-300 CFHR	300	430	7,67										
114-010-01700	EW40-350 CFHR	350	480	8,49										
114-010-01750	EW40-400 CFHR	400	530	9,32										
114-010-01800	EW40-550 CFHR	550	680	11,70										
114-010-01850	EW40-700 CFHR	700	830	14,10										
114-010-01900	EW50-300 CFHR	300	70	60	50		460	3/8"	65	74	50	25,5	47	
114-010-01950	EW50-400 CFHR	400				560	14,00							
114-010-02000	EW50-550 CFHR	550				710	17,50							
114-010-02050	EW50-700 CFHR	700				860	21,00							

Technische Daten am Anfang der Rubrik Zylinder